

PALMA CASSETTE AWNING

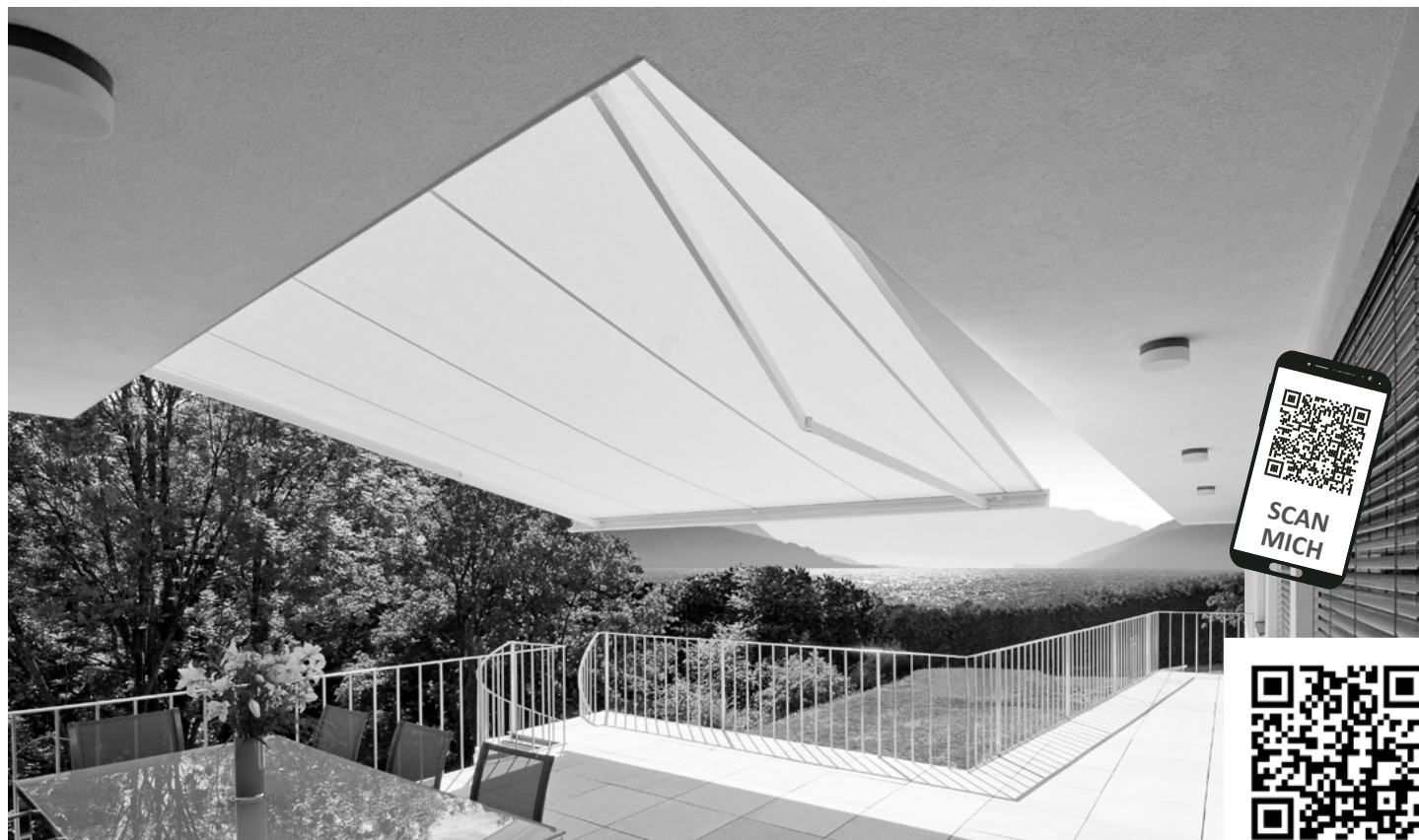

Congratulations on your new VALETTA product. You have chosen a high quality product from Austria. We ask you to carefully read and keep the contents of the assembly instructions. These assembly instructions complete the intended use with the information on assembly and use. The operating instructions must be read before first use. Damage caused by failure to observe the operating and maintenance instructions is not covered by the warranty. Liability for consequential damage to elements of any kind and persons is excluded. This equipment has been supplied and installed by a specialist dealer. Repairs and disassembly may only be carried out by qualified personnel. Do not make any changes to the product yourself. Otherwise safe handling is no longer guaranteed.

With the publication of this document/version, all previous corresponding documents lose their validity. The instructions, drawings and documentation are the complete property of VALETTA Sonnenschutztechnik GmbH and may not be copied or reproduced in whole or in part. Technical changes and printing errors are reserved. The sales and delivery conditions of VALETTA Sonnenschutztechnik GmbH apply without exception. (Current version at www.valetta.at)

MAINTENANCE ADVICE

Regular maintenance and care increases the service life of the system!

Check the system and the operating elements regularly, but at least once a year, for wear or damage (frame, hangings, etc.) Also check the fastening screws and the assembly of the product for stability and strength. Remove possible dirt (leaves, etc.) on a regular basis. Have inspections and maintenance work carried out regularly and preferably only by qualified personnel. Worn or damaged parts must be replaced or repaired in good time and only by a specialist company. Do not use the unit if repairs are necessary.

Only original spare parts approved by the manufacturer may be used.

We recommend that you conclude a service contract. Contact your VALETTA specialist partner.

ATTENTION

Risk of injury due to falling from a climbing aid! Climbing aid (e.g. ladder, etc.) can tip over due to improper setup. Set up the climbing aid on level and stable ground! Do not lean the climbing aid against the product!

Loads that are not intended impair the function and safety of the product!

Incorrect operation and improper use will void the warranty!

QUESTIONS

If you have any questions regarding the installation or operation of this product, please contact your authorized VALETTA dealer.

CARE INSTRUCTIONS

To ensure a long service life, we recommend that you clean the surface of the unit regularly.

BASE:

All aluminum parts are powder-coated and therefore insensitive to weathering. Nevertheless, we recommend cleaning the aluminum parts at regular intervals with clean water and a mild household cleaner (do not use aggressive agents).

AWNING CLOTH:

Awning cloths made of acrylic fabric or Soltis fabric have an anti-rot and dirt-repellent finish and can be washed off with lukewarm water if necessary. Soap suds or additives must not be used for cleaning, otherwise the impregnation will be washed off.

NOTE

- The awning is a sun and privacy protection, not an all-weather protection. It must be retracted in the event of wind, storm, rain or snow (remove snow beforehand!).

- If the fabric was nevertheless retracted wet, open the system after the rain and allow the fabric and construction to dry thoroughly!

ATTENTION: Do not use high pressure cleaner, parts can be damaged under pressure.

ATTENTION: Plants can be started up unintentionally. Ensure that the plant is de-energized (e.g. switch off fuse) during cleaning and maintenance work (e.g. building cleaners) to prevent accidents.

Do not expose the system to building moisture over a longer period of time. In particular, aggressive condensation water from finished plaster or paint can cause corrosion damage to the drive or the operating elements.

OPERATING THE EMERGENCY CRANK

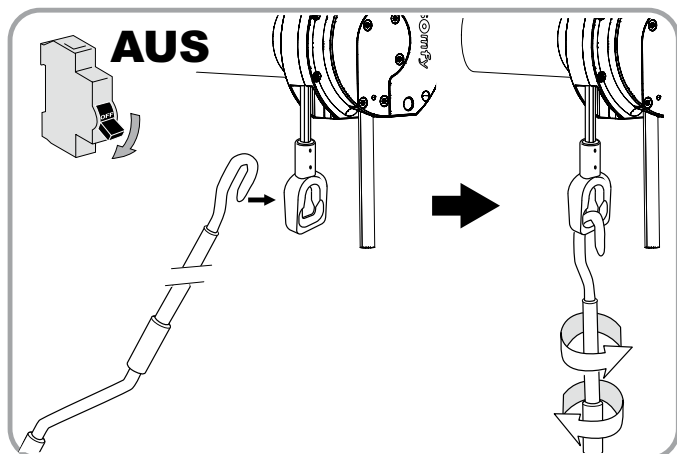

In the event of a fault, if the motor cannot be operated via the switch or the remote control, the awning can be operated via the emergency manual gear integrated in the motor. Access to the emergency manual gear is on the side of the awning.

Never use the emergency crank when a control point is not programmed in the motor!

Never lower the awning below the broken arm position using the crank!

- Check that the mains power supply is off.
- Hook the emergency crank into the crank handle.
- Turn the crank to raise or lower the awning.

NOTICE:

The gearbox is not designed for permanent operation using the emergency hand crank. Operation via the emergency manual gearbox is only set up for emergencies when the engine is not ready for operation!

Further information such as declaration of performance etc. can be found in the download area on our homepage at WWW.VALETТА.AT

SALES-CENTER VIENNA
 Schönbrunner Straße 106, A-1050 Vienna
 T. +43 (0)1 / 667 78 88

VALETTA Sonnenschutztechnik GmbH
 HEADQUATER
 Salzburger Straße 199, A4030 Linz
 T. +43 (0)732 / 38 80- 0
 F. +43 (0)732 / 38 80- 22
 office@valetta.at
WWW.VALETТА.AT